

CONTAINERS AS 4 ONLY OPTION. 2 OTHER FOR ELECTRICIAN & PLUMBER WOULD BE LOCATED ELSEWHERE BUT PAID FOR BY THEM

MIN 450MM SPACE BETWEEN/AROUND CONTAINERS FOR STORAGE (DRAINAGE ETC)

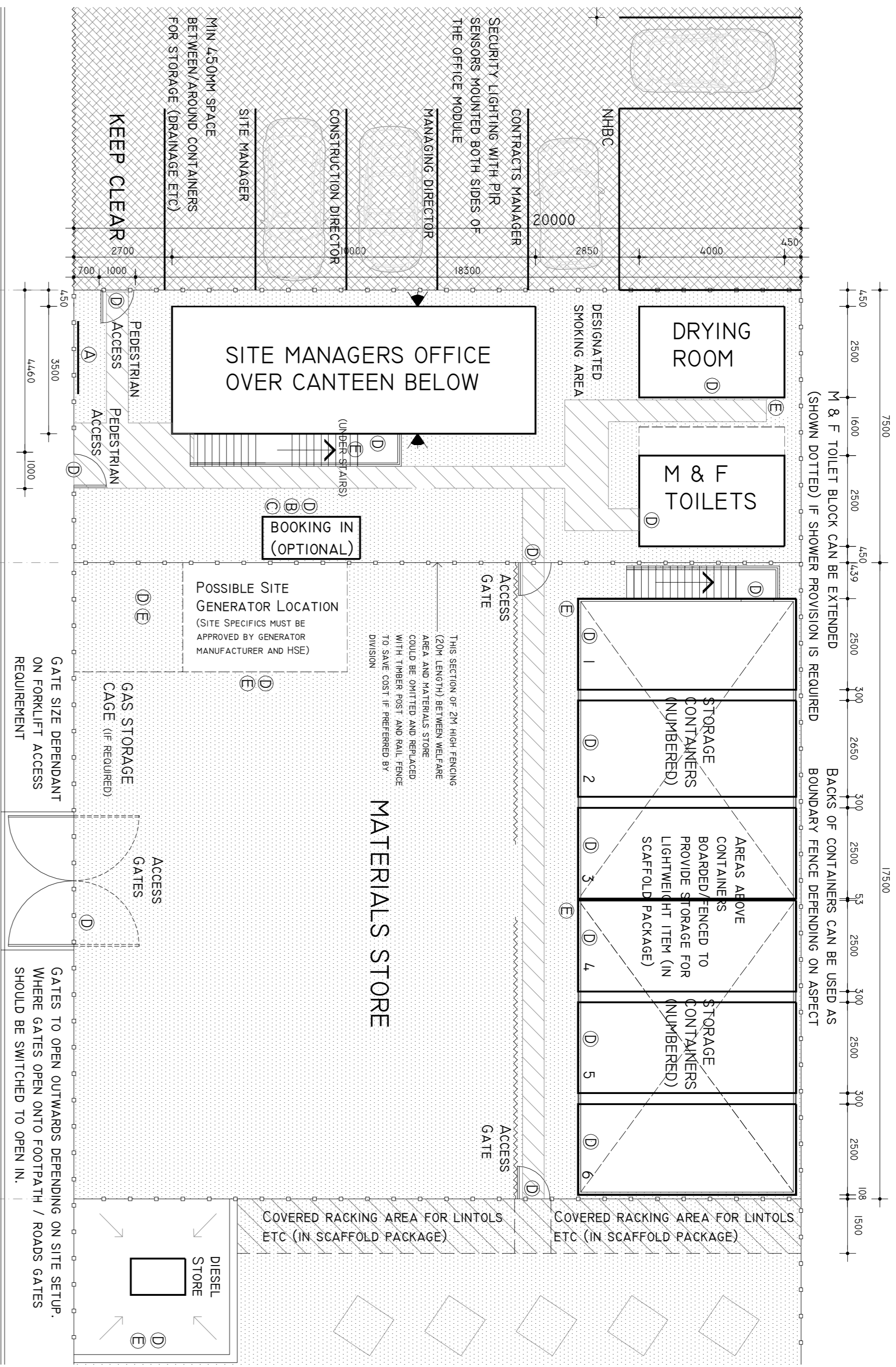

PLAN LAYOUT OF CENTRAL COMPOUND AREA SCALE 1:100

WELFARE MATERIALS STORE & REFUELLING

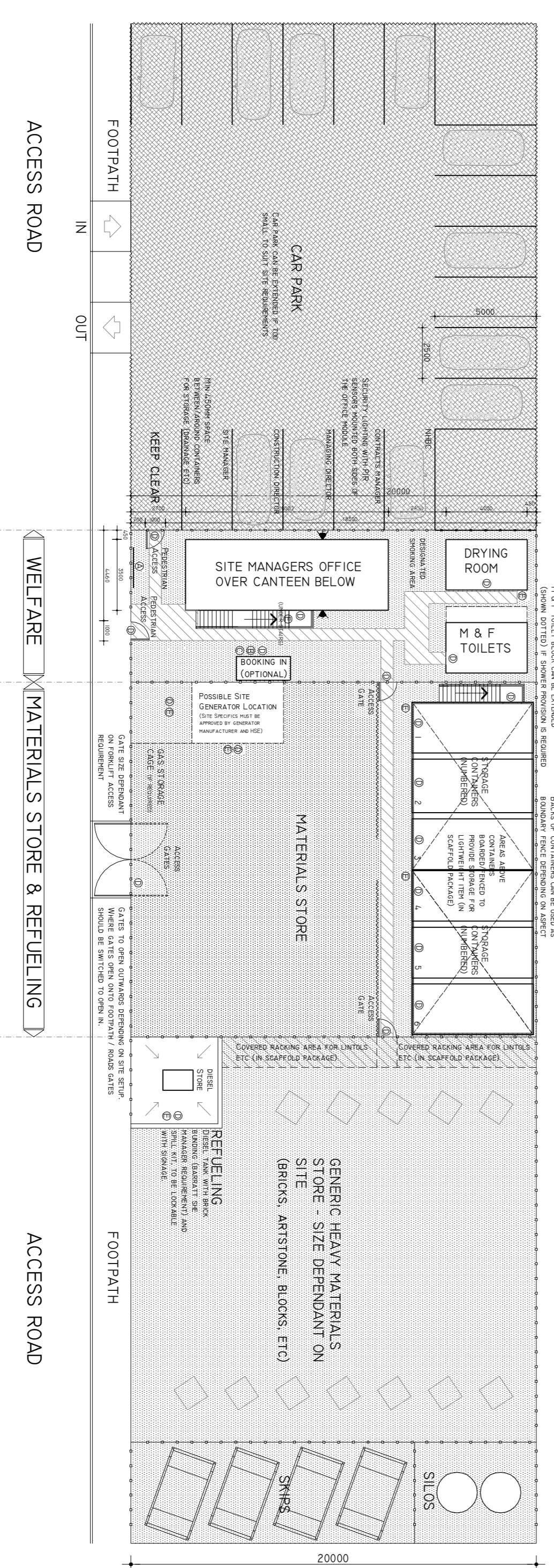

PLAN LAYOUT OF LINEAR SET-UP SCALE 1:200

**KEY**

- 2H HIGH STEEL WALLING, SPRINGING TO MATCH COMPANILE COLORING, SIGNADE TO BE AGREED ON SITE (AS SHOWN). SIZES MAY INCREASE FROM SHOWN AS FULL PANELS MUST BE USED AND NOT CUT.
- 20MM TYPICAL GAP BETWEEN POST AND RAIL FINISHING TO CAR PARK / MATERIAL STORE AREA (AS SHOWN).
- KNEE / FRICTIONER RAIL, PROVIDING PROTECTION / SEPARATION BETWEEN PEDESTRIAN & FORK LIFT ACCESS. OPEN GRAB STEEL TOE (1000MM WIDE, 500MM ABOVE FINISHING TO CAR PARK AREA). GRASSY LEVEL ENCLOSED IN CONCRETE, BALANVED FINISH.
- WHITE LINES ON TERRACE TO WELFARE AND MATERIAL STORE AREAS.
- 75MM TYPICAL GAP OR GRAVEL DEPENDING ON GRASS CONTROL ON ISHBY TRUCK HARBORE ON TERRACE TO CAR PARK AREA.
- SECURITY LIGHTING WITH PIR SENSORS MOUNTED BOTH SIDES OF THE OFFICE MODULE.
- LOW WALL CLEAN STONE OR LIGHT TRUCK HARBORE ON TERRACE TO LARGE MATERIAL STORE, SILO AND SHIP AREAS.
- SITE SAFETY MASTER BOARD - TO BE POSITIONED ABOVE THE STEEL HOARDING.
- OPERATIVE DAILY SIGNING IN STATION (CENTRY BOX).
- EXTERNAL SAFETY NOTICE BOARD AND DAILY HAZARD BOARD.
- NO SMOKING SIGNAGE (PLACED AT ENTRANCE POINTS).
- FIRE EQUIPMENT POINTS - (EACH POINT TO CONSIST OF TWO DIFFERENT TYPES OF EXTINGUISHERS, ALARM & FIRE HOSE). FIRE HOSE TO BE MOUNTED TO WALLS & BE REQUIRED TO BOTH DIESEL AND LPG STORAGE AREAS).

**NOTE -** ADDITIONAL SAFETY AND WARNING SIGNAGE MAY BE REQUIRED DEPENDING ON LOCAL CONDITIONS.

**CONSIDERATE CONSTRUCTOR REQUIREMENTS**

- CANTEEN ON GROUND FLOOR TO HAVE FIRE HOSE/EXTINGUISHER LIGHTING WITH PUSH BUTTON TAPS TO THE SINK. SITE OFFICE ABOVE CANTEEN TO HAVE FIRE HOSE/EXTINGUISHER LIGHTING WITH PUSH BUTTON TAPS TO THE SINK. FIRST AID ROOM TO HAVE FIRE HOSE/EXTINGUISHER LIGHTING AND TAPS TO BE PUSH BUTTON FITTINGS.
- DRIVING SEAT TO HAVE PIR MOUNTED SENSORS. LIGHTING 2.7M HIGH LOCKABLE COVERS INEED TO WALL. 3NO INDIVIDUAL CHANGING ROOMS AND SLATED SEATS TO WELFARE. PERIMETER WALLS WITH HEAVY DUTY COAT HOOKS ABOVE.
- COMBINED MALE AND FEMALE TOILET BLOCK TO HAVE PIR MOUNTED SENSORS LIGHTING WITH PUSH BUTTON TAPS. PINK FLUSH TOILETS AND WATERS SINKS. SHOWER BOTH MALE AND FEMALE IF DESIRED BUT NOTE THAT THE CODE CREDITS CAN BE ACHIEVED WITHOUT PROVIDING A SITE SHOWER.

**NOTE -** ALL EXTERNAL DOORS TO CABINS TO BE FITTED WITH SELF CLOSING MECHANISM.

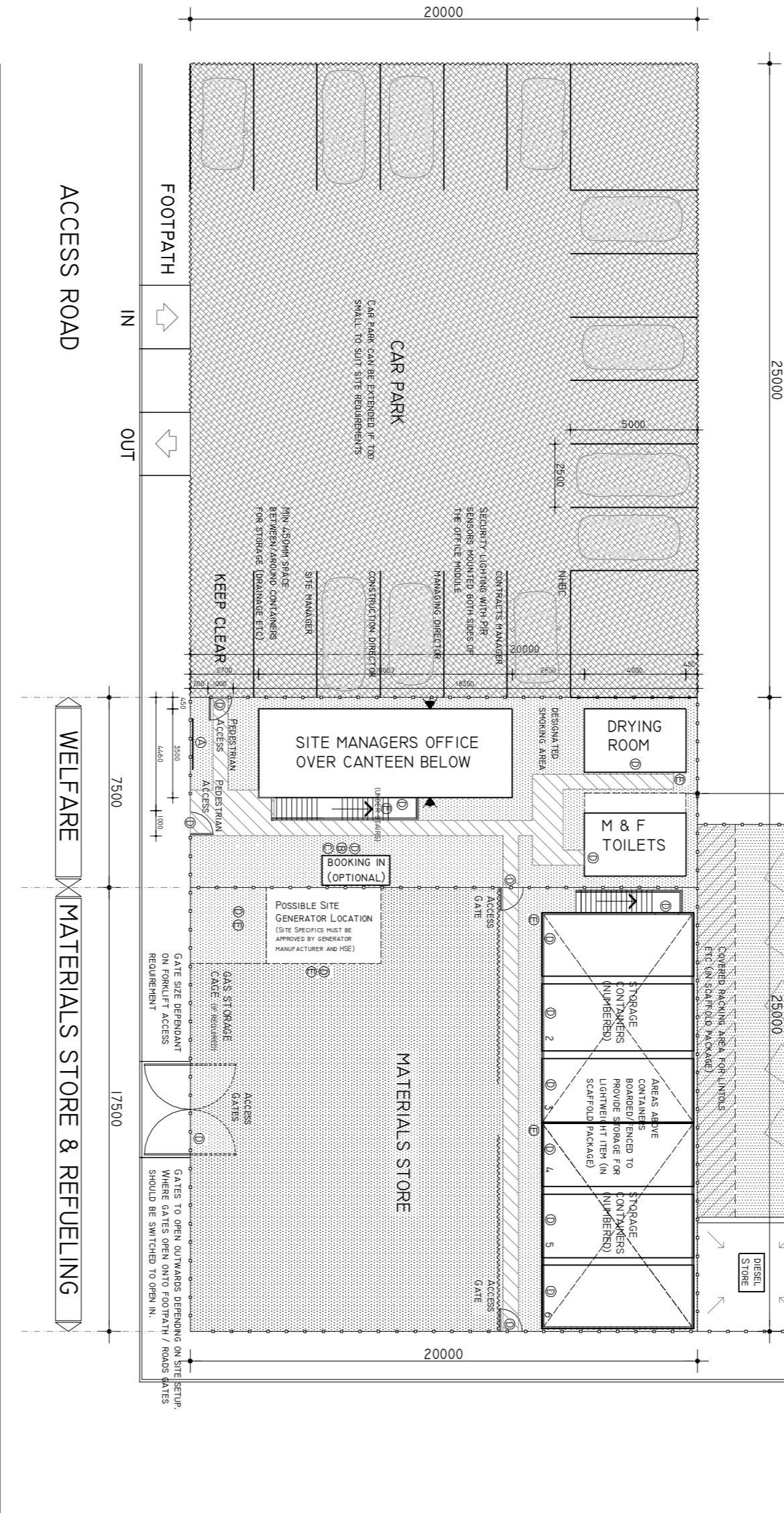

PLAN LAYOUT OF CORNER SET-UP SCALE 1:200

NOTE: WHERE SITE HAS OPEN SPACE AREAS THESE SHOULD BE DEVELOPED AT AN EARLY STAGE OF THE DEVELOPMENT. NO COMPOUND AREAS SHOULD BE LOCATED ON POS AREAS.



NOTE: ALL SITE / HEALTH & SAFETY SIGNAGE TO BE AS THE STANDARD COMPOUND SIGNAGE PACK SHOWN ABOVE

NOTE: SITE SPECIFIC SAFETY BOARD AS SHOWN ON PAGE 1.3 (SECTION 1 - 'SITE SETUP' OF THE 'CONSTRUCTION BEST PRACTICE GUIDE'.) TO INCLUDE INFORMATION ON PPE/SITE RULES/FIRST AID/SMOKING ETC.

SITE SAFETY SIGNAGE SCALE 1:20

(EITHER FREE STANDING OR LOCATED ON PERIMETER HOARDING)

**NOTES:**  
 THIS DRAWING SHOWS A STANDARD 20X25M COMPOUND.  
 CAR PARKING/MATERIALS/SKIPS ETC CAN BE POSITIONED AS SHOWN OPPOSITE ON THE TWO EXAMPLES LINEAR & CORNER SETUP BUT OTHER LAYOUTS WILL SUIT DEFENDANT ON SITE LAYOUT.  
 THIS DRAWING SHOULD BE READ IN CONJUNCTION WITH SECTION 1 - 'SITE SETUP' FROM THE 'CONSTRUCTION BEST PRACTICE GUIDE'.

REV C - MARCH 2012  
 CONSIDERATE CONSTRUCTOR REQUIREMENT NOTE 3 REVISED TO READ THAT THE CODE CREDITS CAN BE ACHIEVED WITHOUT PROVIDING A SITE SHOWER

REV B - JANUARY 2012  
 CONSIDERATE CONSTRUCTOR REQUIREMENT NOTES ADDED

REV A - JULY 2011

STORAGE CONTAINERS REPOSITIONED TO CREATE ONE BLOCK BIN WITH STORAGE OVER. 1 NO STAIRCASE REMOVED. FOOTPATHS REMOVED TO STORAGE UNITS WHERE FEASIBLY SHOWN. UNITS BEING REPOSITIONED. 1.2M HIGH TUBES FENCE SIGNING TO PROVIDE SEPARATION BETWEEN STORAGE UNITS AND MATERIALS STORE WITH A SMALL GAP FORMED FOR ACCESS AS SHOWN.  
 NOTE ADDED TO PROVIDE 4 UNIT OPTION IF PREFERRED.  
 NOTE ADDED REGARDING HEALTH & SAFETY SIGNAGE TO BE USED.  
 PLACE OF TRUCKING BUT DEPENDS ON ASPECT.  
 TOLLET BLOCK SHOWN AS EXTENDABLE IF SHOWER PROVISION IS REQUIRED.  
 ACCESS GATES TO MATERIALS STORE (SUCH AS OTHER TOWER OR OUTWARD OPENING) DEPENDANT ON SITE SETUP.  
 MATERIALS CONTROLLER AREA REMOVED AND REPLACED WITH SMALL BOOKING IN UNIT. RELOCATED TO HEAVY MATERIALS STORE AND GAS STORAGE POSITION REVISED AS SHOWN.  
 CAR PARKING BAYS NOTED FOR VARIOUS PERSONNEL.  
 SHED AREAS ON SITE.  
 NOTE ADDED REGARDING HEALTH & SAFETY SIGNAGE TO BE USED.  
 NOTE ADDED AS OPTION FOR REMOVAL OF 2H HIGH STEEL FENCE BETWEEN WELFARE AREA AND MATERIALS STORE. TIMBER POST AND RAIL USED AS OPTION TO REDUCE COSTS.

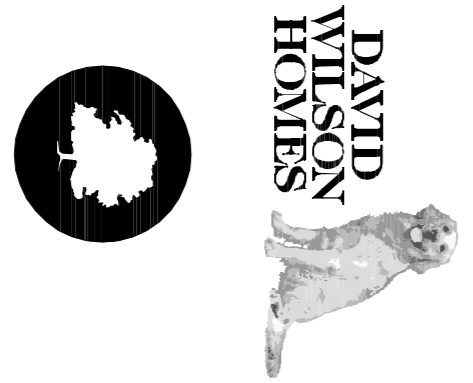

**BARRATT**  
 DEVELOPMENTS PLC  
 HOUSE TYPE  
 GENERIC STANDARD SITE  
 COMPOUND

TITLE  
 SITE COMPOUND LAYOUTS  
 SCALES 1/100 & 1/200  
 DATE SEPT '10  
 Dwg. No. 2010/DET/SC01C